

## RE-FLEX SHOCK™



Re-Flex Shock offers the best vertical shock absorption of all the Össur mechanical feet. With dynamic energy return and all around responsiveness the foot is a great choice for active users.

The composite spring in front provides optimal shock absorption that reduces impact subjected to the body. Enhancing both control and comfort during walking and other activities.

The Unity vacuum suspension system is available as an addition to the Re-Flex Shock™ foot module. Unity in combination with Iceross Seal-In technology provides elevated vacuum in the socket during ambulation, without the restricting effect of an external sealing sleeve. Unity adds minimal weight to the existing prosthesis and does not interfere with the superior function of Re-Flex foot and shock modules.



ÖSSUR FEET

User Information	
Amputation Level:	Transfemoral and Transtibial
Impact Level:	Low to High
Maximum Patient Weight:	166kg

 PROPORTIONAL RESPONSE	 CARBON-X® ACTIVE HEEL	 FULL LENGTH TOE LEVER
 ACTIVE TIBIAL PROGRESSION	 VERTICAL SHOCK PYLON	 SPLIT TOE

Foot Information	
Categories:	1-9
Sizes:	22-30
Weight: (Size 27)	1048g w/ Foot Cover
Build Height Standard: (Size 27)	210 - 238mm w/ Foot Cover and Male Pyramid
Build Height Tall: (Size 27)	255 - 288mm w/ Foot Cover and Male Pyramid
Heel Height:	10mm, 19mm available on special order
Adapter:	Male Pyramid

Unity System Information	
Maximum Vacuum:	-600mmHg
Normal Operating Vacuum:	-16-20 inHg
Added System Weight:	130g w/ Pump, Socket Valve and Tube

# RE-FLEX SHOCK™

## ORDERING INFORMATION

FOR COMPLETE FOOT\*

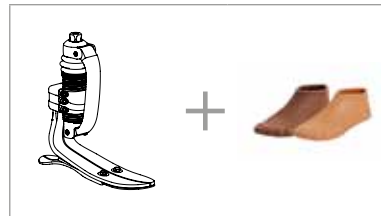

Unity can be ordered with Re-Flex Shock in the standard foot module height. Please select the appropriate Unity Pump Module kit according to foot module size when placing an order and Unity will come preassembled on the foot. For extra convenience and system compatibility, Unity Valve Kits are highly recommended as a means of connecting to the socket.

FOR COMPLETE FOOT WITH UNITY

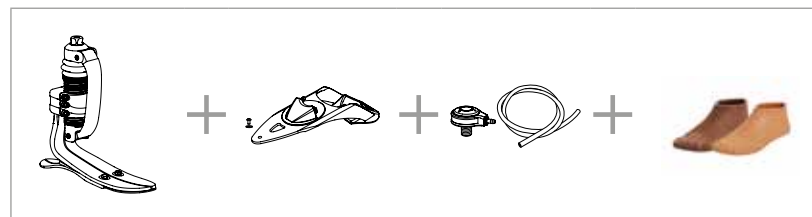

\*Foot module also available in tall profile

## CATEGORY SELECTION CHART

Weight kg	45-52	53-59	60-68	69-77	78-88	89-100	101-116	117-130	131-147	148-166
Low Impact Level	1	1	2	3	4	5	6	7	8	9
Moderate Impact Level	1	2	3	4	5	6	7	8	9	N/A
High Impact Level	2	3	4	5	6	7	8	9	N/A	N/A



# RE-FLEX SHOCK™

## DIMENSIONS

### RE-FLEX SHOCK STANDARD FOOT MODULE

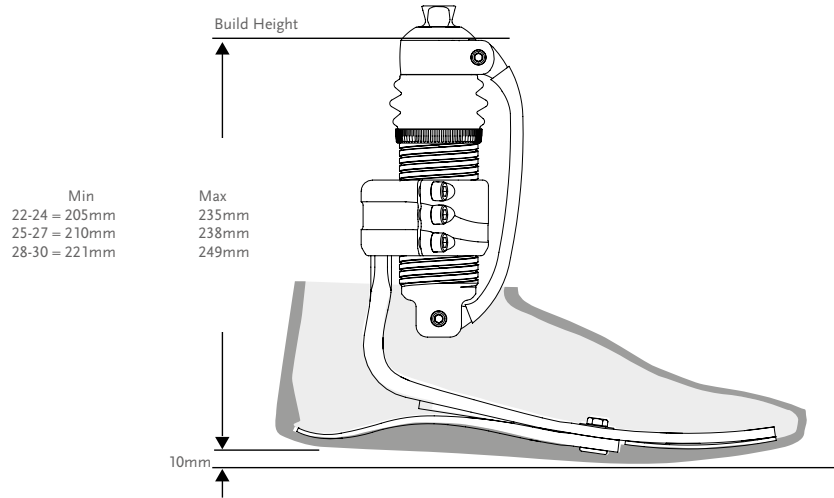

### RE-FLEX SHOCK TALL FOOT MODULE

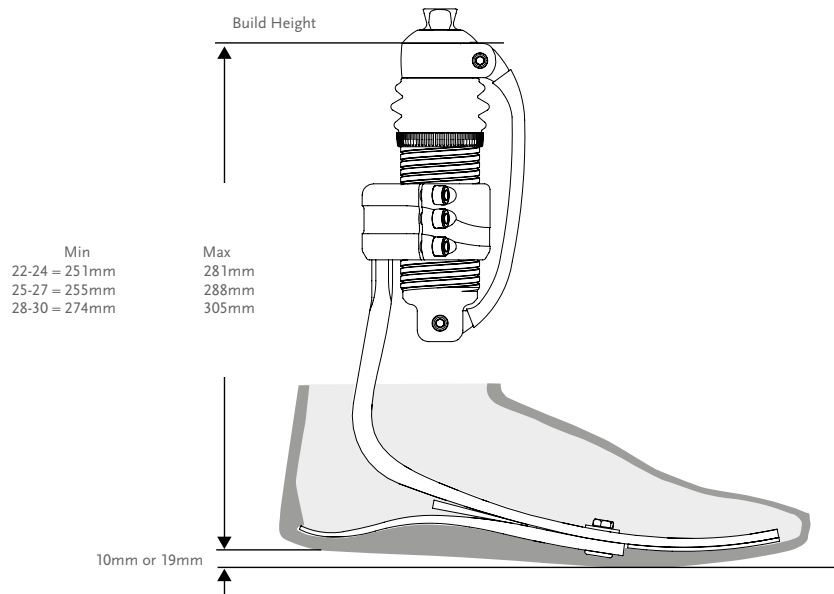

\*Note: Re-Flex Shock with Unity has the same build height as Re-Flex Shock.

# RE-FLEX SHOCK™

## KITS

### STANDARD PROFILE WITH SHOCK

MALE PYRAMID ATTACHMENT

PART#

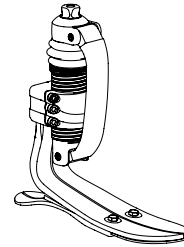
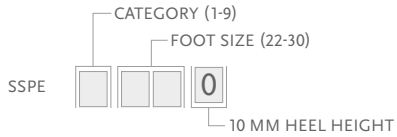

### TALL PROFILE WITH SHOCK

MALE PYRAMID ATTACHMENT

PART#

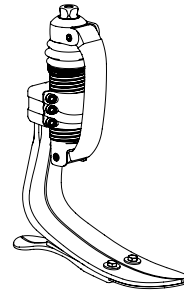
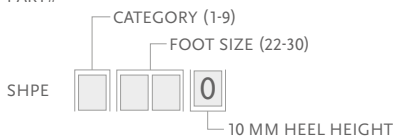

PART#

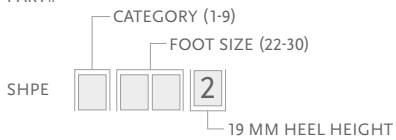

Includes:

- Foot Module
- Shock Module with Carbon Front Spring
- Heel Wedges

Shock Kit Includes:

- Male Pyramid Shock Module
- Loctite

Note: Solid toe is a special order.

### STANDARD PROFILE WITHOUT SHOCK

PART#

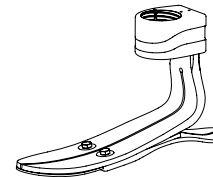
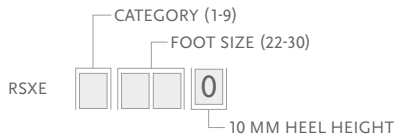

Note: 19mm heel height for standard profile, foot size 25-30, available upon special order.

# RE-FLEX SHOCK™

## KITS

### TALL PROFILE WITHOUT SHOCK

PART#

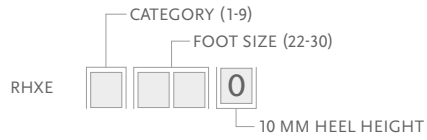

PART#

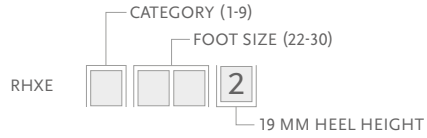

Includes:

- Foot Kit

Note: Solid toe is a special order.

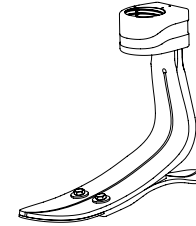

### SHOCK KITS

#### MALE SHOCK KIT

PART#

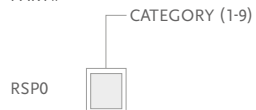

## COMPONENTS

### HEEL WEDGE KITS

Tall and Standard Profile Foot Module	Foot Size	Cat.
CM150011	22-30	All

Includes:

- 3 Wedges
- Adhesive



Part#	Description
CM160025	Loctite 243

# RE-FLEX SHOCK™

## COMPONENTS

### FRONT SPRINGS

Part#	Cat.
RSS44001	1
RSS44002	2
RSS44003	3
RSS44004	4
RSS44005	5
RSS44006	6
RSS44007	7
RSS44008	8

Includes:

- Front Spring
- 2 Pins

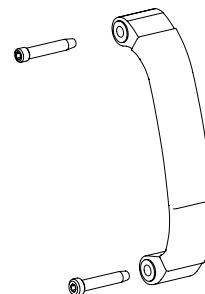

### BUSHING KIT

Part#	Description
RSS00001	Bushing Kit

Includes:

- 4 Bushings
- 2 Pins

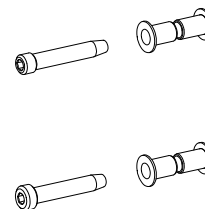

### LOWER RING

Part#	Description
RSS40011	Re-Flex Shock Bellow
RSS40012	Re-Flex Shock Collar

## TOOLS

### TORQUE WRENCH

Part#	Description
FFC798001	Torque Wrench 3Nm Preset



# RE-FLEX SHOCK™

## UNITY

### UNITY KITS

Picture	Part#	Description	Applicable Foot Kits
1	URS0024	Unity Pump Module RSX 22-24	Re-Flex Std Size 22-24
1	URS0027	Unity Pump Module RSX 25-27	Re-Flex Std Size 25-27
1	URS0030	Unity Pump Module RSX 28-30	Re-Flex Std Size 28-30
2	UTT0001	Unity TT Valve Kit	All
3	UTF0001	Unity TF Valve Kit	All
4	UTF0006	Unity TF Tube Kit	All

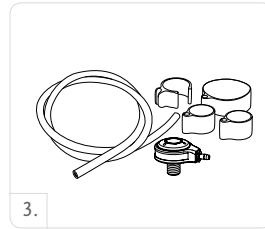
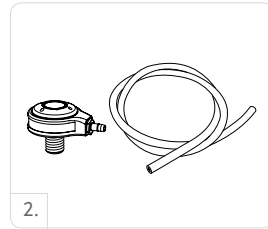

### SPARE COMPONENTS

Part#	Description
URS00021	Unity RS Components, 22-24
URS00022	Unity RS Components, 25-30

Includes:

- Membrane
- Check valves
- Barb fittings
- Tube
- Tube fastener
- Heel pad

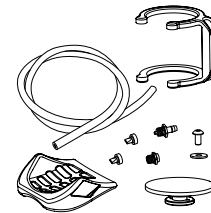

### FOOT KITS APPLICABLE WITH UNITY

#### RE-FLEX SHOCK™ STANDARD PROFILE

MALE PYRAMID ATTACHMENT

PART#

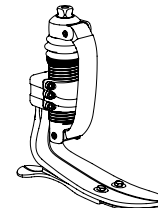

Caution: Due to restricted space with the Re-Flex Shock shock module and Unity, SSPE\* kits allow for only 2 full turns of downwards adjustment from the tallest setting. Re-Flex Rotate modules can be set to any height within their designed limits.

# RE-FLEX SHOCK™

## COSMETIC FINISHING

### FOOT COVER KIT, BEIGE AND BROWN\*

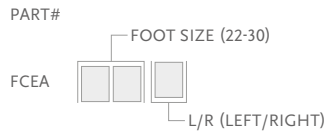

Includes:

- Foot Cover
- Flex-Foot Sock
- Foot Cover Attachment

\*Please specify when ordering brown covers, add "BR" to the end of the part number.

### FLEX-FOOT SOCKS

Used to cover the composite foot module to protect the foot and eliminate noise between foot module and foot shell.

Part#	Size
FCE63006	22-25
FCE63007	26-30





# RE-FLEX SHOCK™

## DIAGRAM

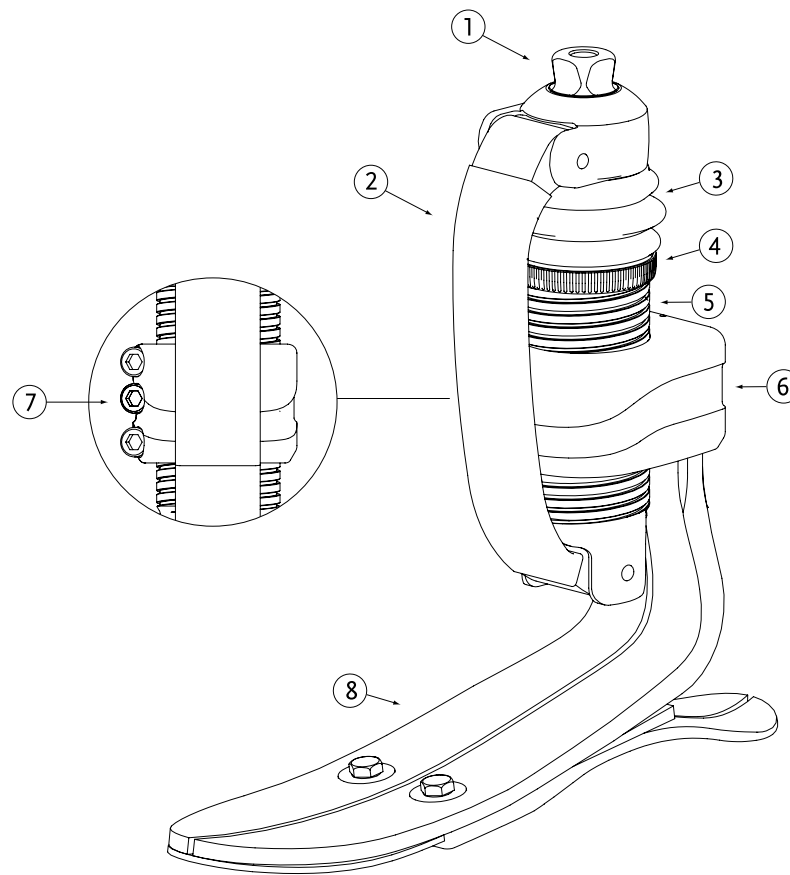

	Description
1.	Male Pyramid
2.	Front Spring
3.	Bellow
4.	Collar
5.	Threaded Outer Tube
6.	Fixed Attachment Clamp
7.	Attachment Clamp Screws
8.	Foot Module